

Download and Run the "ELabel" App on Android, iPhone, iPad

"ELabel" App is a label edit software, not a shipping platform. It can meet a variety of printing needs, whether for household or commercial usage. If you do most of your business on your phone, you can upload your print files, including 4x6" shipping label, by PDF to "ELabel" App and print.

1. Download the "ELabel" App from App Store or Google Play

iOS



Android

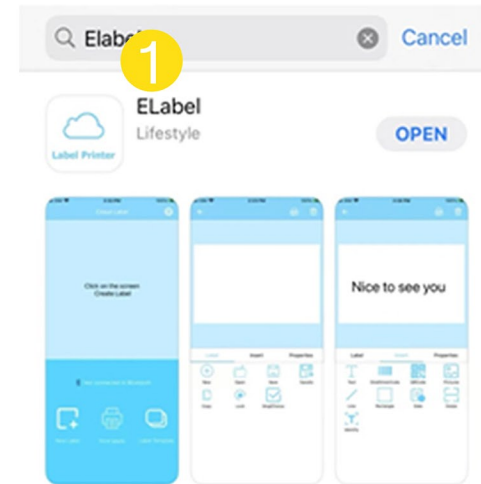

2. Run "ELabel" App on iPhone, iPad

! Note:

Before printing from App, pls make sure that your WU550 printer is on and has been connected to WiFi. Ensure your iPhone/iPad device is on the same network with the printer.

2.1: Connect "ELabel" App to WiFi

Choose WIFI -> Input the IP address in the host column and port address in the port column and "connect". You can find the IP information from WIFI Configure label or Self Test label.

! Note:

If you restart your printer, pls remember to restart the "ELabel" App too, the App WIFI will be connected automatically. You don't need enter the IP info each time. If your printer IP info changed, you need update it to App too.

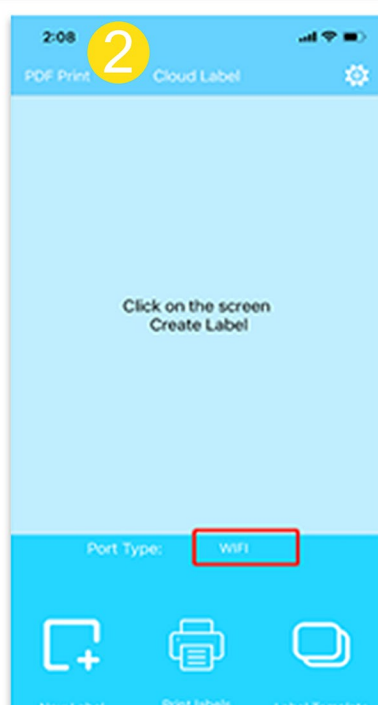

2.2: Create New Labels

Create new label by inputting the width and height. Edit the information and set the Properties. You can set the Font/Font size and others from Properties. Then tap the printer icon for printing.

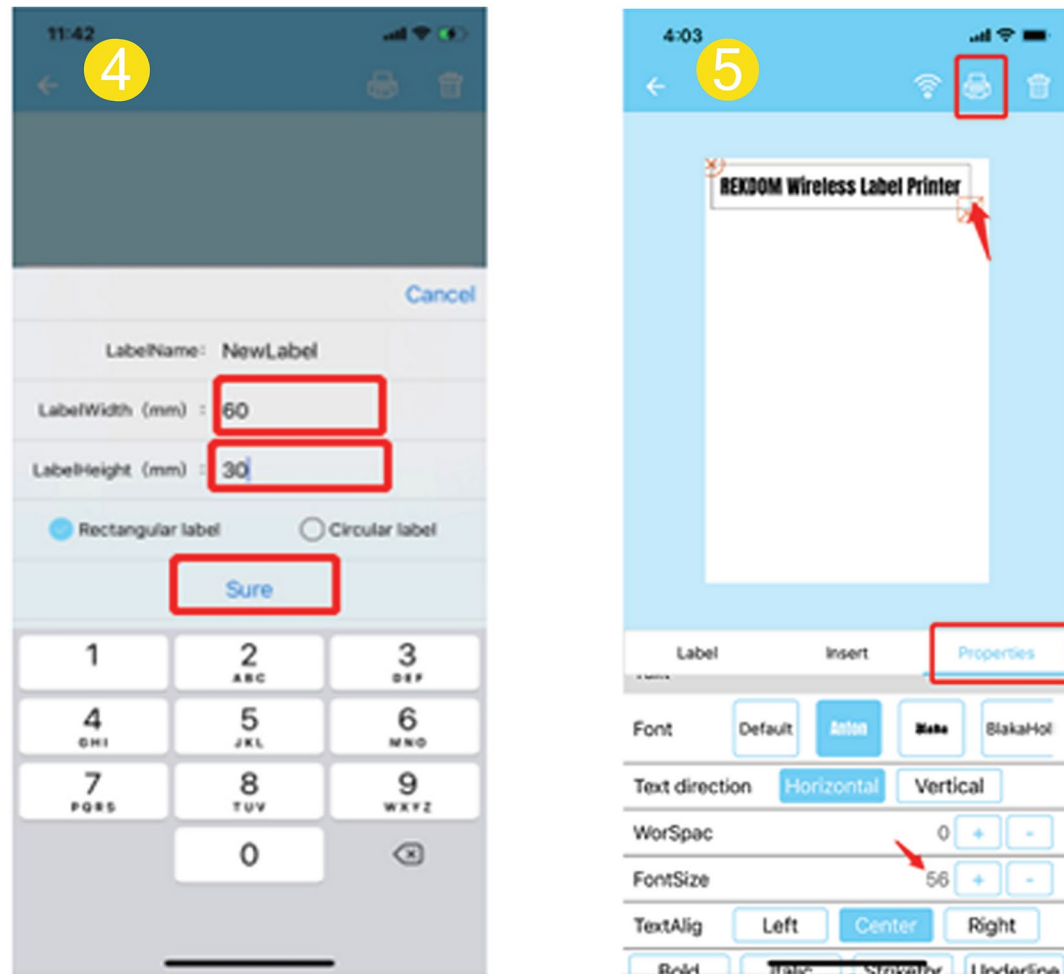

2.3: PDF Print

Open your label file and choose "Open in Other App", it will save as Files if you choose "Save to Files" and it will save as Imported PDF if you choose "ELabel". Then back to PDF print and choose the files to print.

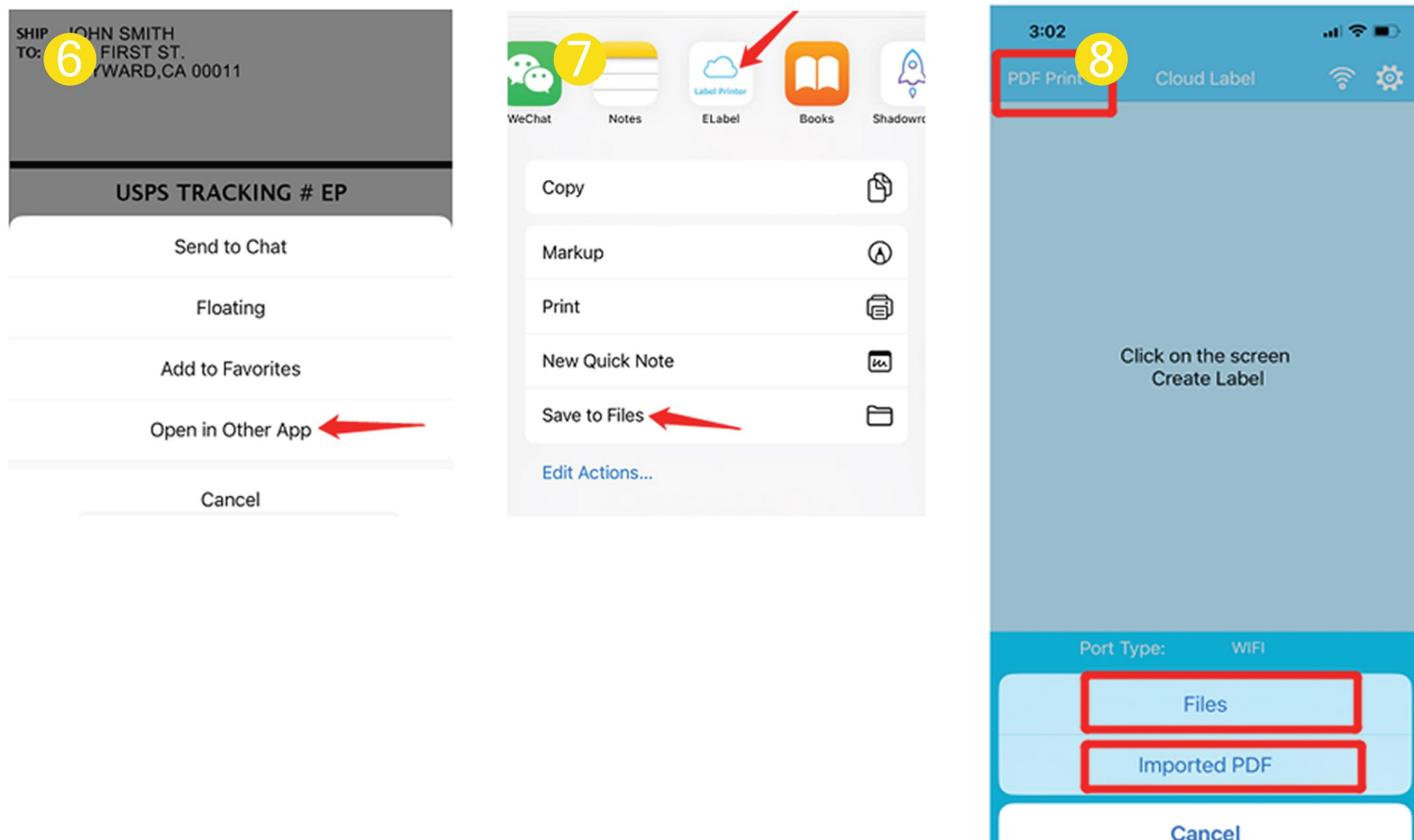

! Note:

Our default size for PDF print with 80mmx120mm, pls remember to change it to 100x150mm size or others if you print 4x6" shipping label or others. Ensure your label page size match the label paper size.

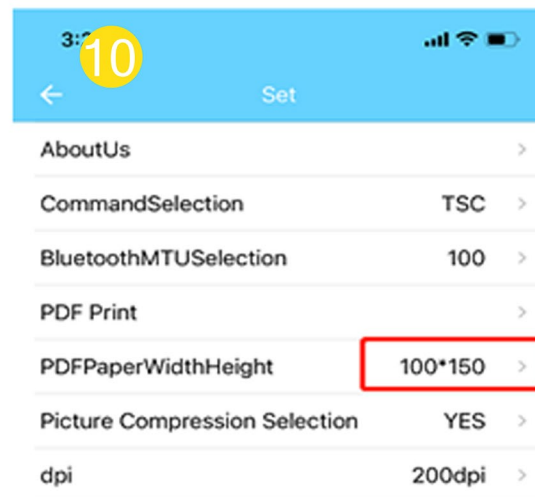
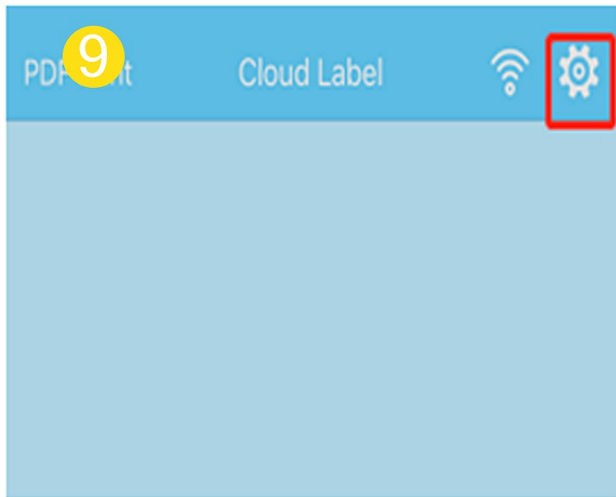

3. Run "ELabel" App on Android

! Note:

Before printing from App, pls make sure that your WU550 printer is on and has been connected to WiFi. Ensure your Android device is on the same network with the printer.

3.1 Connect "ELabel" App to WiFi

Choose Wifi -> Input the IP address and port address and "ok". You can find the IP information from WIFI Configure label or Self Test label.

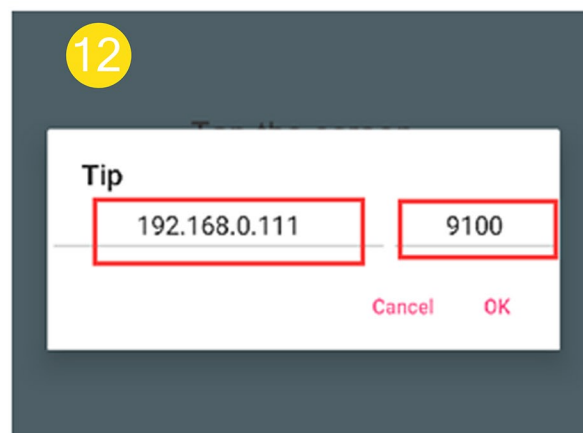
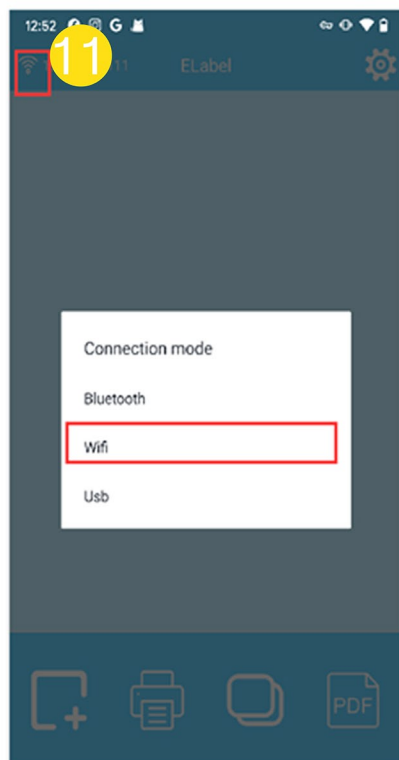

3.2: Create New Labels

Create new label by inputting the width and height. Edit the information and set the **Attributes**. You can set the Font/Font size and others from **Attributes**. Then tap the printer icon for printing.



3.1 Connect "ELabel" App to WiFi

Open your label file directly, it will save as Documents if you choose " Save", then back to "ELabel", choose PDF and choose the file from Documents to print. Pls refer to the picture 14 to 16.

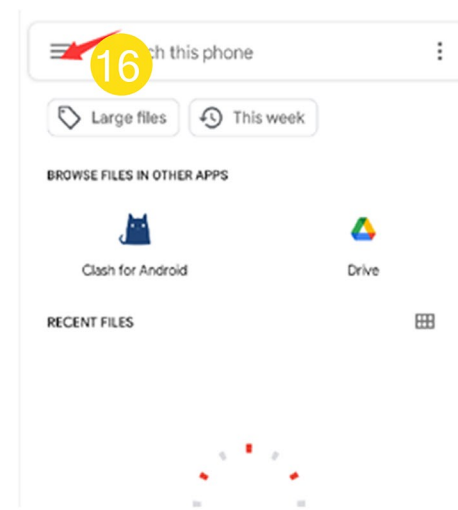
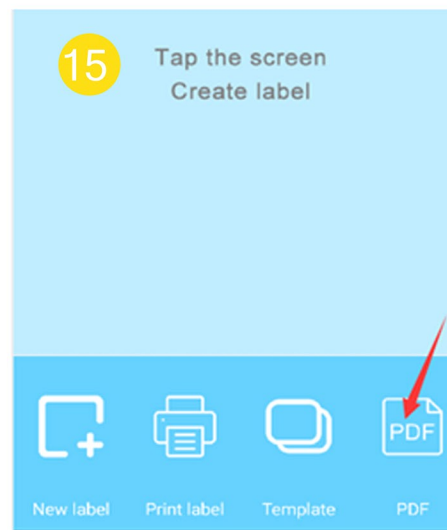
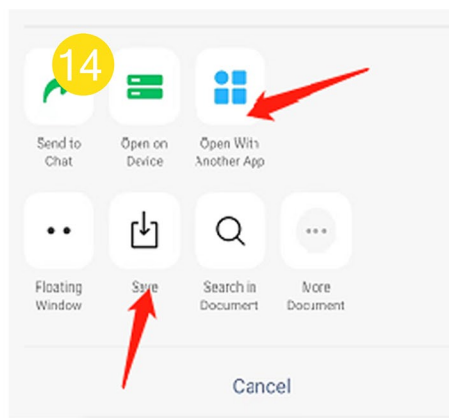

If you choose "Open with Another App", pls choose ELabel to print. Pls refer to the picture 14, 17 to 19.

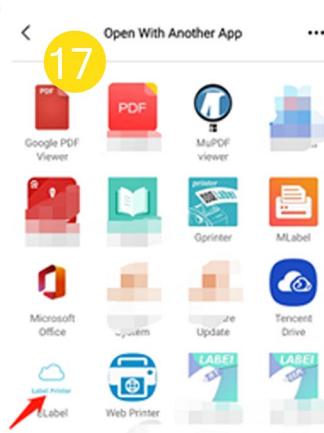

Any problems, please contact Customer Support, thank you.

✉ Email : info@reksomprinter.com

☎ Phone : 840 200 7908(text)

Best Regards
REKDOM

